

Accessories

Centering Bracket

For LS-5 Series

LSAB2

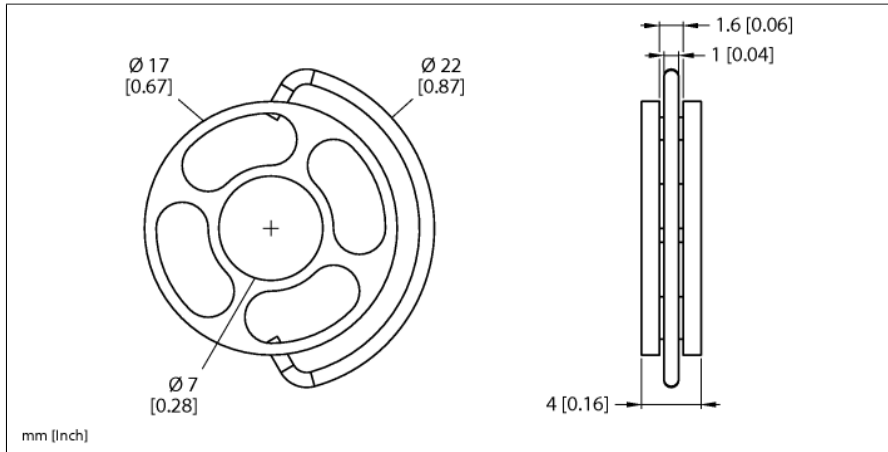

- Centering bracket for probes in the LS-5 product series
- For mounting in LSCT-xx-xxxx coaxial tubes

Type	LSAB2
ID	100016515
Application area	liquids
Mechanical data	
Materials (contact with media)	PTFE
Included in delivery	1 × flat seal, 3 × spacer

Functional principle

The level sensors of the LS-5 series work according to the principle of the guided microwave. The so-called Time Domain Reflectometry (TDR) is used. This method emits an electromagnetic wave along the probe. When the wave reaches the medium, it is partially reflected due to the dielectric constant compared to air. The electromagnetic wave is picked up again by the sensor and the distance to the liquid can now be determined via the transit time.